



**Whiteriver Unified School District #20**  
**PO Box 190 Whiteriver, AZ 85941 (928) 358-5800**  
**Amendment #1**

**RFP 15-01-20**  
**E-Rate Internal Connections**  
**Category 2**  
**Internal Connections**

**February 4, 2015**

**Material or Service: E-Rate Priority I – Management of Internal Broadband Service**

**Proposal Responses Due on or before: March 2, 2015 by 9:00 a.m. Mountain Standard Time**

**Proposals Received will be received at: 963 South Chief Ave, Whiteriver, AZ 85941**

**Proposals Received will be opened at: WUSD – IT Offices, 963 South Chief Avenue, Whiteriver, AZ 85941**

This amendment is released to provide interested parties with additional information or clarifications.

1. Can our Firm attend the preconference via phone or WebEx?  
Answer: The District does not have the staffing to do this and we will be “touring” the campuses. You should plan on the Preconference lasting 6-8 hours.
2. Will there be a recording of the preconference?  
Answer: No. However, should the scope of work or any terms and conditions change an amendment will be issued ASAP and posted to the District’s website.
3. Could the District provide maps of the school sites prior to the preconference?  
Five pages of maps follow this one.
4. Will there be more than one preconference?  
The District is only planning one. However, should four or fewer vendors attend, the District reserves the right to schedule an additional one to promote competition and fairness in an open market.
5. Remember to acknowledge this and any other Amendments on the form provided in the original RFP, Page 55.
6. All other terms and conditions remain the same.
7. End of Amendment #1.



**Whiteriver Unified School District #20**  
**PO Box 190 Whiteriver, AZ 85941 (928) 358-5800**  
**Amendment #1**

**RFP 15-01-20**  
**E-Rate Internal Connections**  
**Category 2**  
**Internal Connections**

February 4, 2015

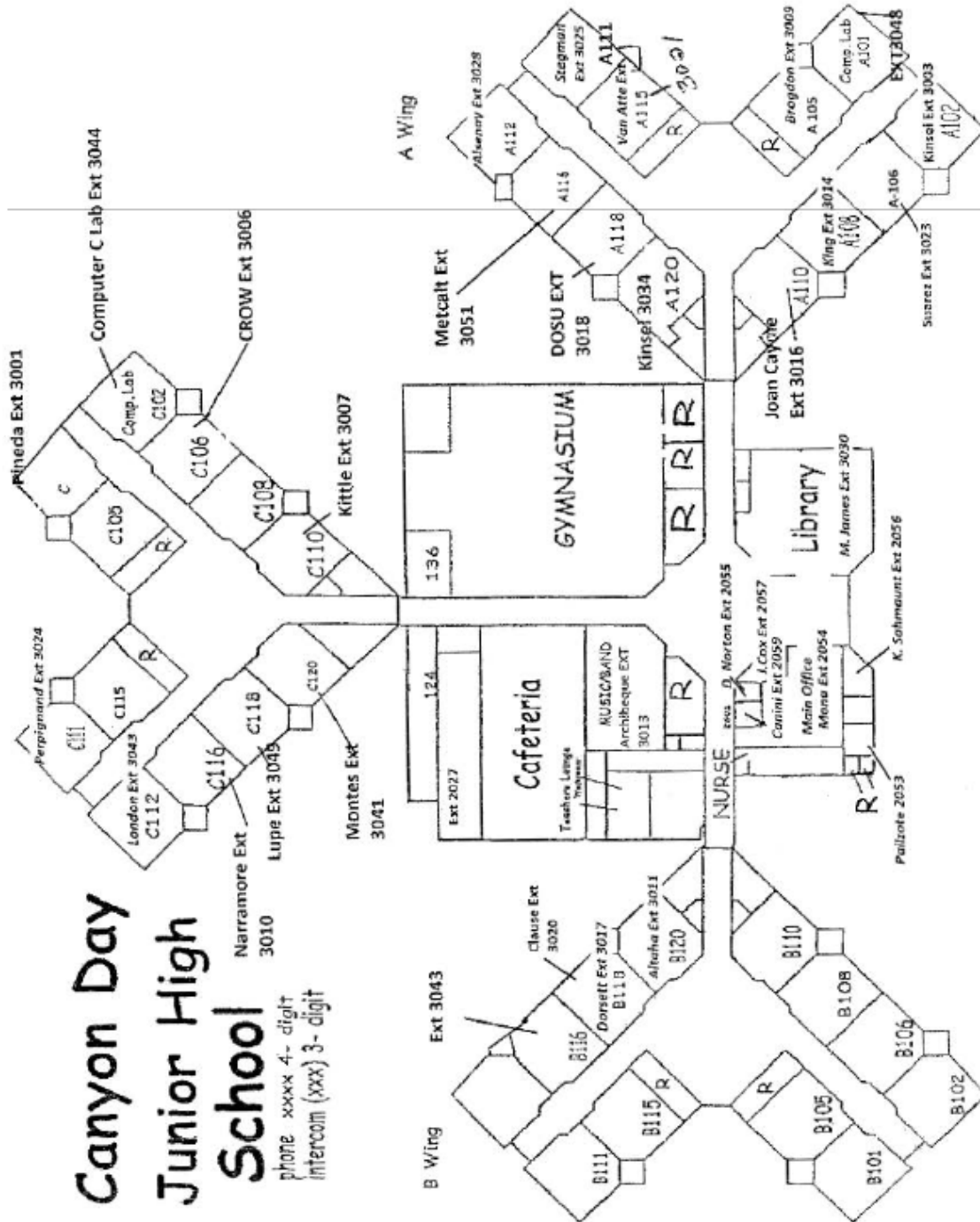



**Whiteriver Unified School District #20**  
**PO Box 190 Whiteriver, AZ 85941 (928) 358-5800**  
**Amendment #1**

**RFP 15-01-20**  
**E-Rate Internal Connections**  
**Category 2**  
**Internal Connections**

February 4, 2015

7 - Mile Elementary  
 Softball field





February 4, 2015

# **RADLEBOARD ELEMENTARY SCHOOL EVACUATION PLAN**

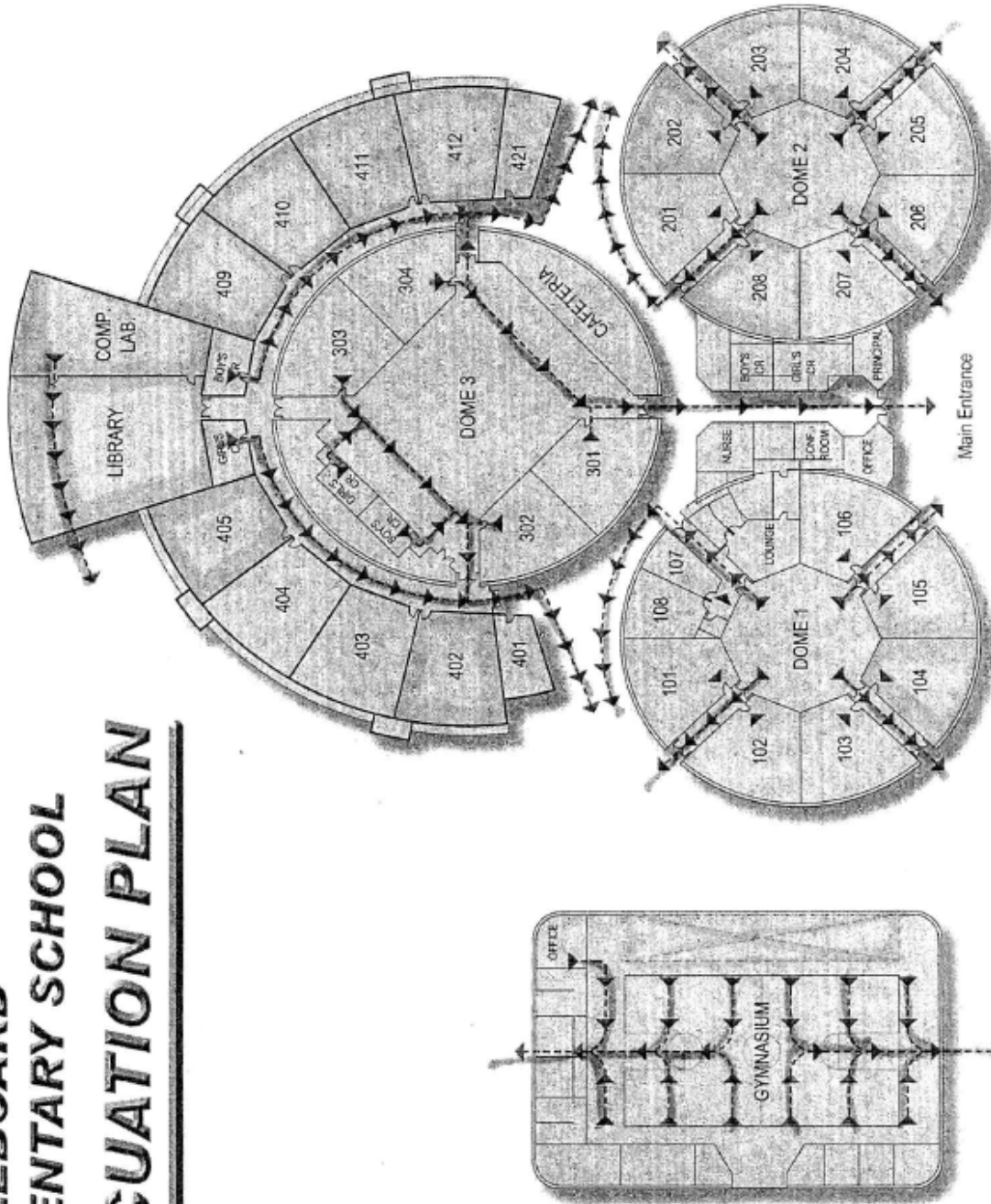

red by RBDmahawat2011



**Whiteriver Unified School District #20**  
**PO Box 190 Whiteriver, AZ 85941 (928) 358-5800**  
**Amendment #1**

**RFP 15-01-20**  
**E-Rate Internal Connections**  
**Category 2**  
**Internal Connections**

February 4, 2015

# Whiteriver Elementary School Map 2012-2013

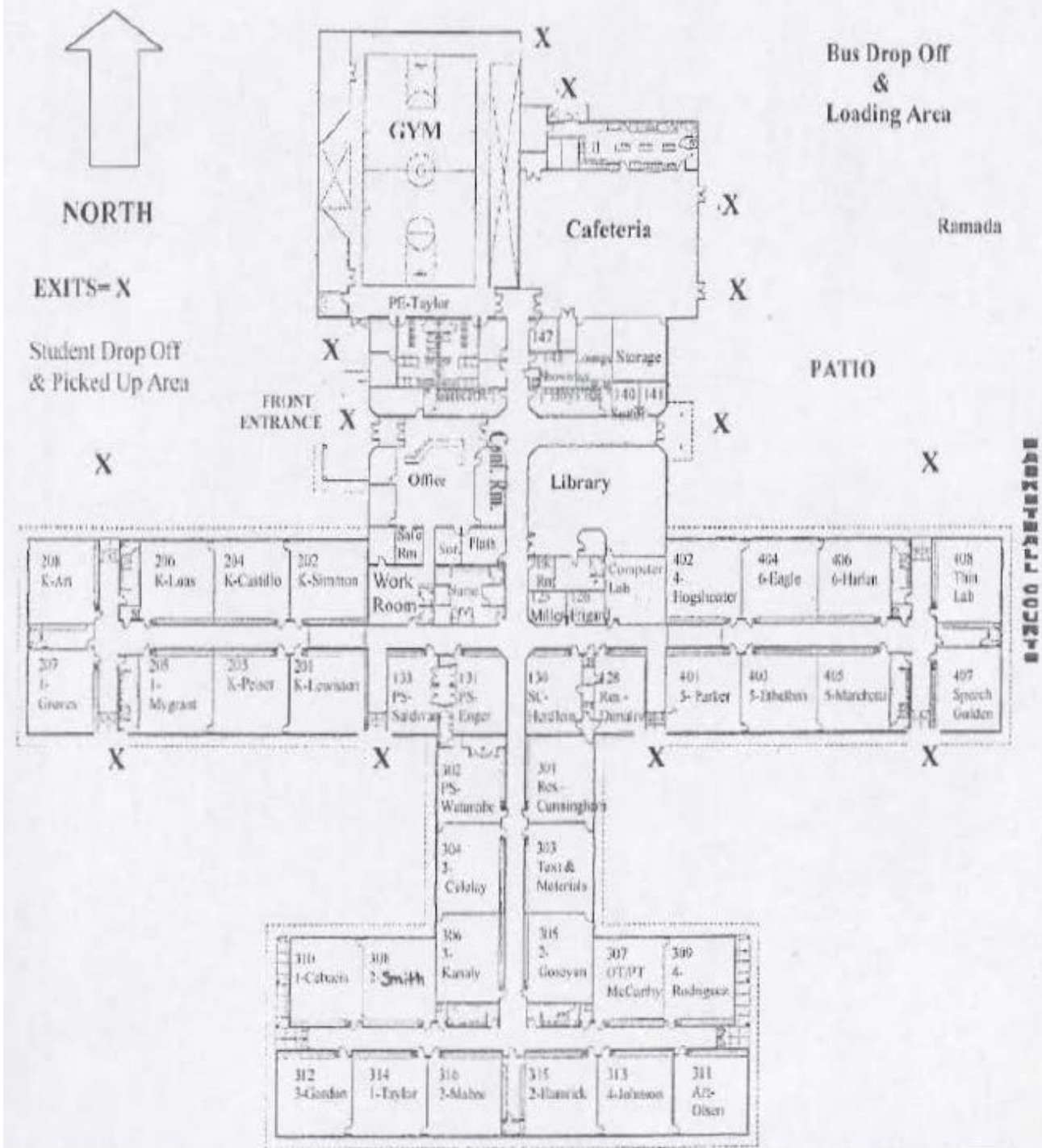



**Whiteriver Unified School District #20**  
**PO Box 190 Whiteriver, AZ 85941 (928) 358-5800**  
**Amendment #1**

**RFP 15-01-20**  
**E-Rate Internal Connections**  
**Category 2**  
**Internal Connections**

February 4, 2015

